

THIS DRAWING IS THE PROPERTY AND  
 COPYRIGHT OF MILLFIELD CONSTRUCTION  
 COMPANY AND MAY NOT BE USED OR COPIED  
 WITHOUT THE EXPRESS WRITTEN PERMISSION  
 OF MILLFIELD CONSTRUCTION COMPANY

**Millfield**  
 CONSTRUCTION COMPANY  
 2130 MARIETTA AVENUE  
 P.O. BOX 6370  
 LANCASTER, PA 17603  
 717-293-0293

(4) UNIT TOWNHOUSE AT:  
**PEREGRINE: OSPREY #10**  
 4334 HEATHER LANE  
 COLUMBIA, PA 17512  
 WEST HEMPFIELD TOWNSHIP

DATE:  
 DECEMBER 8, 2025

LATEST REVISION  
 DATE:  
 DECEMBER 29, 2025

PROJECT NO.  
 NDS 25-87

DWG NO.

**A305**

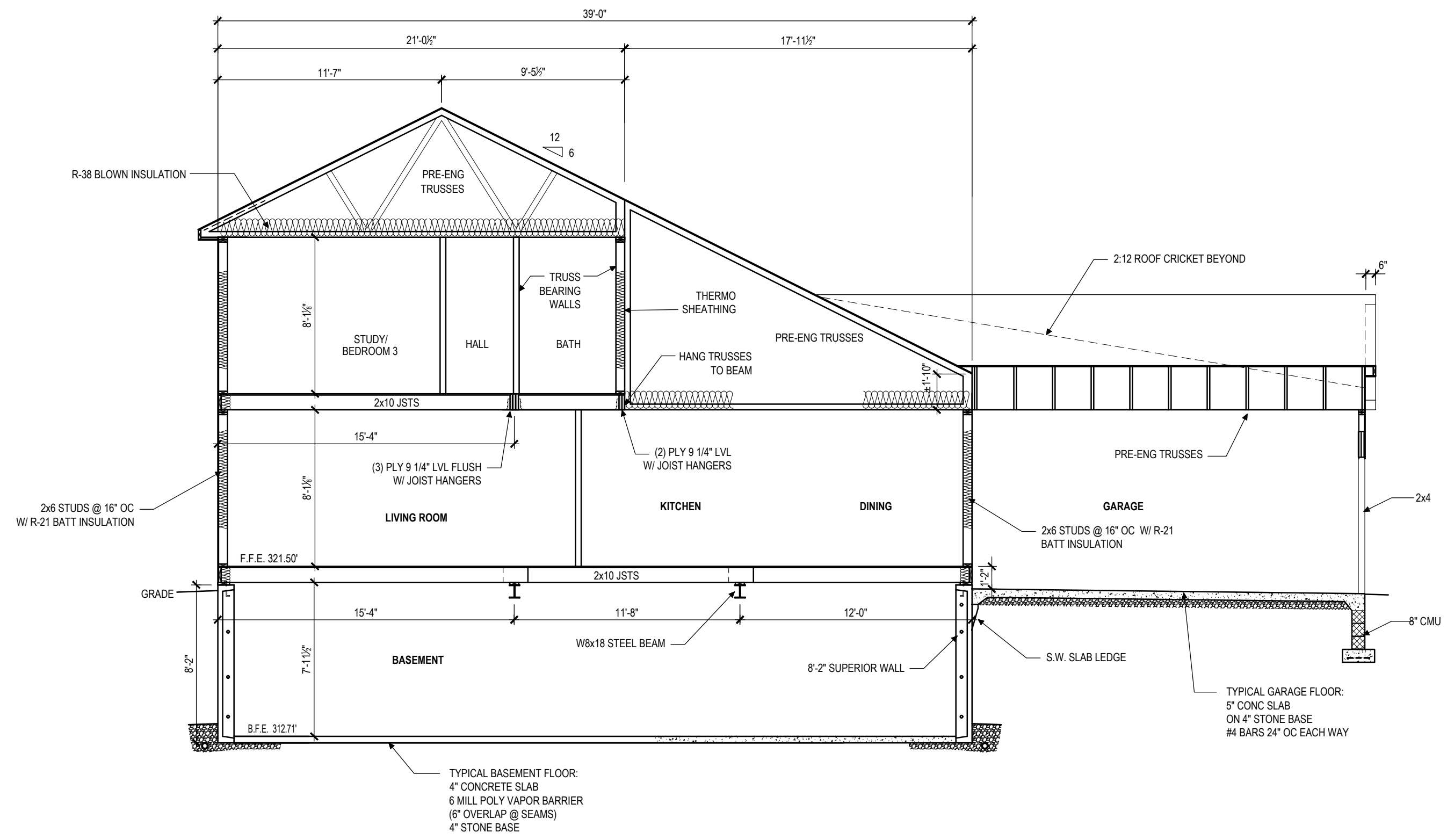

**1**  
 A305 **OSPREY - SECTION 'A'**  
 SCALE: 3/16"=1'-0"